

These parts are specially manufactured in two metre lengths from a wide range of sizes and designs for which tooling is available. All parts can be supplied cut to size and drilled or tapped to suit the specific application. Minimum order quantities will apply.

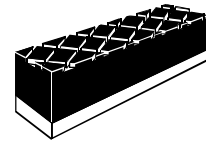

**Type A**

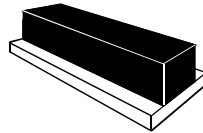
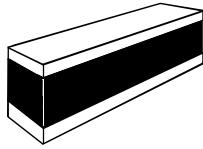
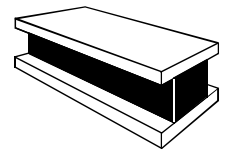
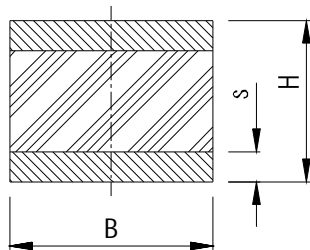
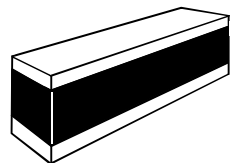

Compounds Produced: 40° Shore A (Soft)  
 (Natural Rubber) 55° Shore A (Medium)  
 70° Shore A (Hard)

Note: Manufactured In Two Metre Lengths

Breadth B (mm)	Height H (mm)	Plate Thickness s (mm)	Min Order Quantity
20	30	5, 8, 10	6
25	25	5, 8, 10	6
25	30		
30	25	5, 8, 10	6
30	30		
40	20	5, 8	6
40	35	10, 15	
40	40		
40	45		
50	35	5, 8	6
50	40	10, 15, 20	
50	45		
50	50		
50	55		
50	60		
50	70		
60	30		6
60	35		
60	40	5, 8	
60	50	10, 15, 20	
60	60		
60	80		
70	30	5, 8	4
70	40	10, 15, 20	
70	45		
70	50		
70	55		
70	60		
70	70		
70	80		

Breadth B (mm)	Height H (mm)	Plate Thickness s (mm)	Min Order Quantity
80	45	5, 8	4
80	60	10, 15, 20	
80	80		
90	45	5, 8, 10, 15, 20	4
100	20	5, 8	4
100	30	10, 15, 20	
100	40		
100	45		
100	50		
100	55		
100	60		
100	65		
100	70		
100	80		
120	45	5, 8	2
120	50	10, 15, 20	
120	60		
120	70		
120	80		
150	50	5, 8	2
150	60	10, 15, 20	
150	65		
150	70		
150	80		
150	100		
200	80	5, 8, 10, 15, 20	1
200	100		
250	100	5, 8, 10, 15, 20	1
300	100	5, 8, 10, 15, 20	1
400	100	5, 8, 10, 15, 20	1

Type F

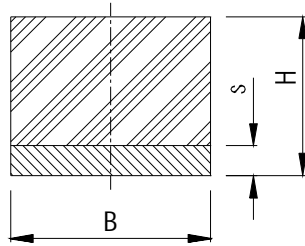
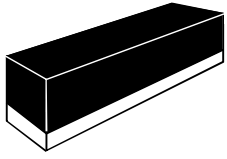

Compounds Produced: 40° Shore A (Soft)  
 (Natural Rubber) 55° Shore A (Medium)  
 70° Shore A (Hard)

Note: Manufactured In Two Metre Lengths

Breadth B (mm)	Height H (mm)	Plate Thickness s (mm)	Min Order Quantity
20	30	5, 8, 10, 15	6
25	25	5, 8, 10, 15	6
25	30		
30	25	5, 8, 10	6
30	30		
40	20	5, 8	6
40	35	10, 15, 20	
40	40		
40	45		
50	35	5, 8	6
50	40	10, 15, 20	
50	45		
50	50		
50	55		
50	60		
50	70		
60	30		6
60	35		
60	40	5, 8	
60	50	10, 15, 20	
60	60		
60	80		
70	30	5, 8	4
70	40	10, 15, 20	
70	45		
70	50		
70	55		
70	60		
70	70		
70	80		

Breadth B (mm)	Height H (mm)	Plate Thickness s (mm)	Min Order Quantity
80	45	5, 8	4
80	60	10, 15, 20	
80	80		
90	45	5, 8, 10, 15, 20	4
100	20	5, 8	4
100	30	10, 15, 20	
100	40		
100	45		
100	50		
100	55		
100	60		
100	65		
100	70		
100	80		
120	45	5, 8	2
120	50	10, 15, 20	
120	60		
120	70		
120	80		
150	50	5, 8	2
150	60	10, 15, 20	
150	65		
150	70		
150	80		
150	100		
200	80	5, 8, 10, 15, 20	1
200	100		
250	100	5, 8, 10, 15, 20	1
300	100	5, 8, 10, 15, 20	1
400	100	5, 8, 10, 15, 20	1

**Type A11**

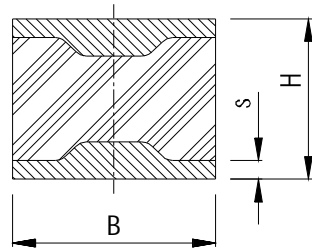
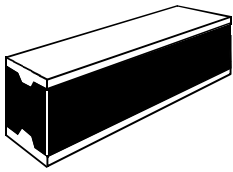

**Type F11**

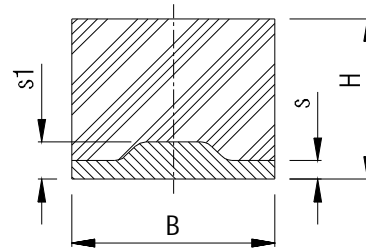
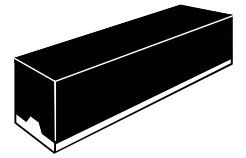

Compounds Produced: 40° Shore A (Soft)  
 (Natural Rubber) 55° Shore A (Medium)  
 70° Shore A (Hard)

Note: Manufactured In Two Metre Lengths

Breadth B (mm)	Height H (mm)	Plate Thickness s (mm) s1		Min Order Quantity
		s (mm)	s1	
50	35	5	10	6
50	40	5	10	
50	45	5	10	
50	50	5	10	
50	55	5	10	
50	60	5	10	
50	70	5	10	
60	35	5	11	6
60	60	5	11	
70	30	5	12	4
70	45	5	12	
70	55	5	12	
70	60	5	12	
70	70	5	12	
70	80	5	12	
100	40	5	15	4
100	45	5	15	
100	50	5	15	
100	55	5	15	
100	60	5	15	
100	70	5	15	
100	80	5	15	

Breadth B (mm)	Height H (mm)	Plate Thickness s (mm) s1		Min Order Quantity
		s (mm)	s1	
50	35	5	10	6
50	40	5	10	
50	45	5	10	
50	50	5	10	
50	55	5	10	
50	60	5	10	
50	70	5	10	
60	35	5	11	6
60	60	5	11	
70	30	5	12	4
70	45	5	12	
70	55	5	12	
70	60	5	12	
70	70	5	12	
70	80	5	12	
100	40	5	15	4
100	45	5	15	
100	50	5	15	
100	55	5	15	
100	60	5	15	
100	70	5	15	
100	80	5	15	

Type B

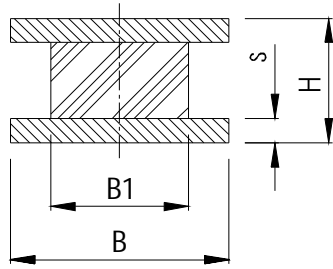
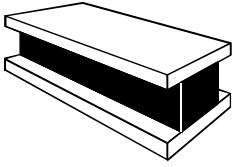

Compounds Produced: 40° Shore A (Soft)  
 (Natural Rubber) 55° Shore A (Medium)  
 70° Shore A (Hard)

Note: Manufactured In Two Metre Lengths

Sizes Available Are As For Rail Type A

Type C

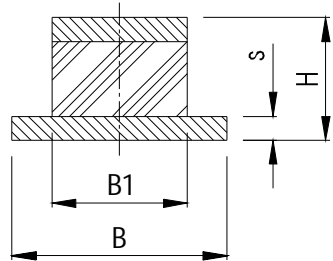
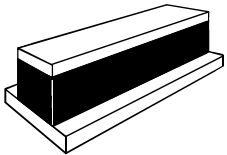

Compounds Produced: 40° Shore A (Soft)  
 (Natural Rubber) 55° Shore A (Medium)  
 70° Shore A (Hard)

Note: Manufactured In Two Metre Lengths

Sizes Available Are As For Rail Type A

Type D

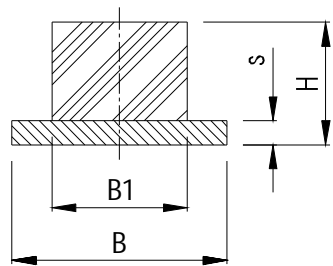
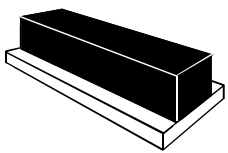

Compounds Produced: 40° Shore A (Soft)  
 (Natural Rubber) 55° Shore A (Medium)  
 70° Shore A (Hard)

Note: Manufactured In Two Metre Lengths

Sizes Available Are As For Rail Type F

Profiled

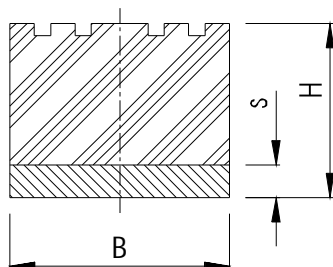
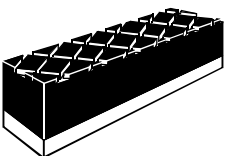

Compounds Produced: 40° Shore A (Soft)  
 (Natural Rubber) 55° Shore A (Medium)  
 70° Shore A (Hard)

Note: Manufactured In Two Metre Lengths

Sizes Available Are As For Rail Type F

Type U

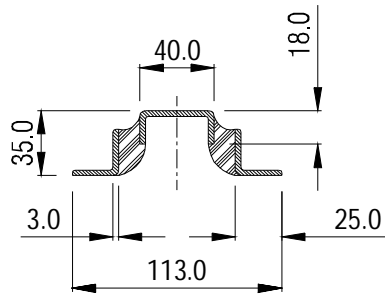
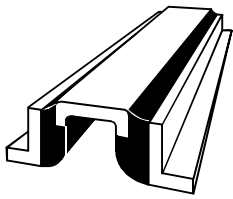

Part No. RAIL-U-RA1554

Compounds Produced: 40° Shore A (Soft)  
 (Natural Rubber) 55° Shore A (Medium)  
 70° Shore A (Hard)

Note: Manufactured In Two Metre Lengths

Rectangular Buffers Cut From Rail

It is possible to manufacture Rectangular Buffers from Rail as illustrated. The Rail can be supplied as manufactured in 2 metre lengths, or can be cut and drilled to meet the customer's individual requirement. This process has the added advantage that no tooling is normally required.

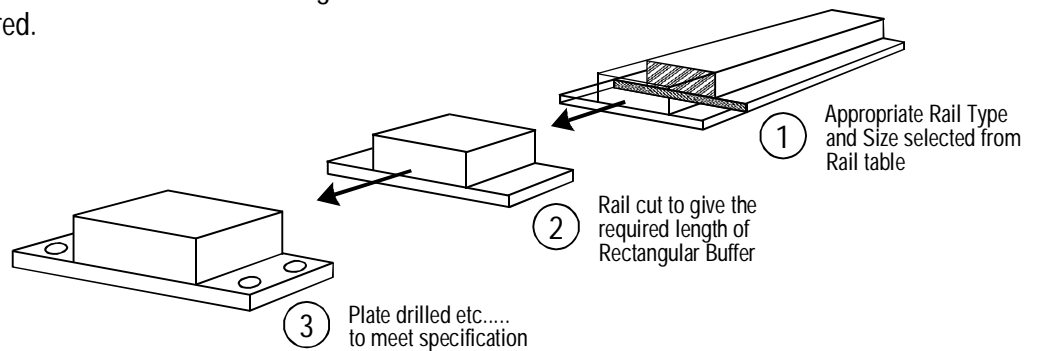

Mountings Cut From Rail

It is possible to manufacture Mountings from Rail as illustrated. The Rail can be supplied as manufactured in 2 metre lengths, or can be cut and drilled to meet the customer's individual requirement. This process has the added advantage that no tooling is normally required.

